

COVID-19 Drive-Up Testing Center Instructions

Do NOT eat, drink, smoke or chew gum for 30 minutes before collecting the sample.



Fill the tube with saliva to the level of the black wavy line (not including bubbles).

Do not overfill.

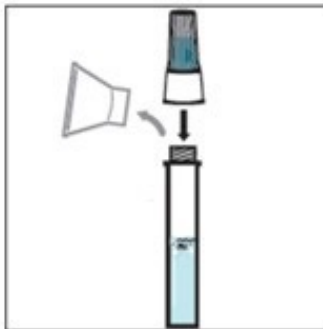

Remove the funnel from the tube.



Screw the enclosed cap TIGHTLY until the blue solution in the cap empties into the tube.



Shake the tube gently for 5 seconds.



Wipe the entire outside of the tube and cap with the alcohol pad and dispose of the pad.

Place tube in the bag.

- Please read the instructions above and follow the step-by-step instructions.
- All paperwork in your bag should be filled out and remain in the bag.
- All barcode stickers should be left in the bag.
- Once the test sample is collected, please drop it in the drop-off bin outside the Korean Long Term Care building.
The container is labeled "COVID-19 Saliva drop off."
- Your results will be posted to your patient portal in 24 – 48 hours.

Instructions for how to access your results are found on the reverse side of this page.

Access Your Results in the Bergen New Bridge Medical Center Online Patient Portal

Go to NewBridgeHealth.org

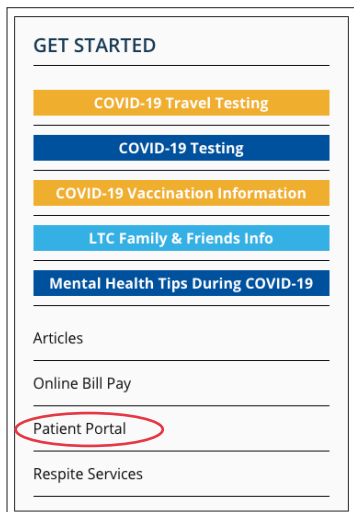

GET STARTED

- COVID-19 Travel Testing
- COVID-19 Testing
- COVID-19 Vaccination Information
- LTC Family & Friends Info
- Mental Health Tips During COVID-19

Articles

Online Bill Pay

Patient Portal

Respite Services

Find the "Get Started" Column, Click on "Patient Portal"

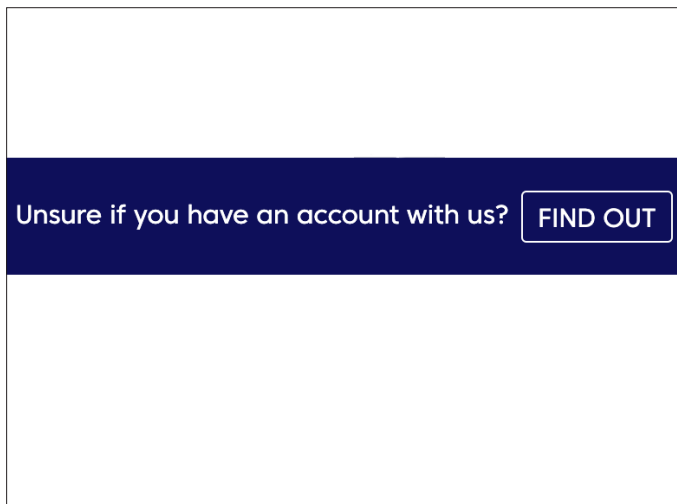

Unsure if you have an account with us? **FIND OUT**

Unsure if you have an account already? Click on "Find Out"

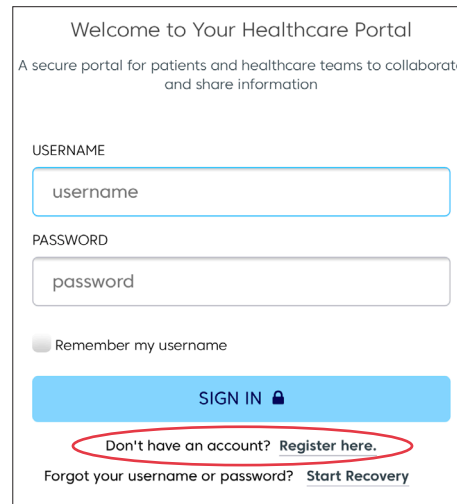

Welcome to Your Healthcare Portal

A secure portal for patients and healthcare teams to collaborate and share information

USERNAME
username

PASSWORD
password

Remember my username

SIGN IN

Don't have an account? **Register here.**

Forgot your username or password? [Start Recovery](#)

Don't have an account? Click on "Register Here"

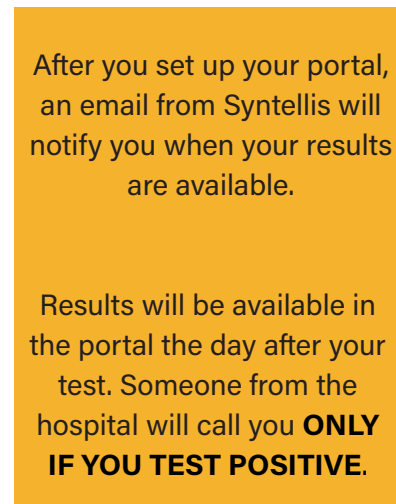

After you set up your portal, an email from Syntellis will notify you when your results are available.

Results will be available in the portal the day after your test. Someone from the hospital will call you **ONLY IF YOU TEST POSITIVE.**

Once In the Patient Portal:

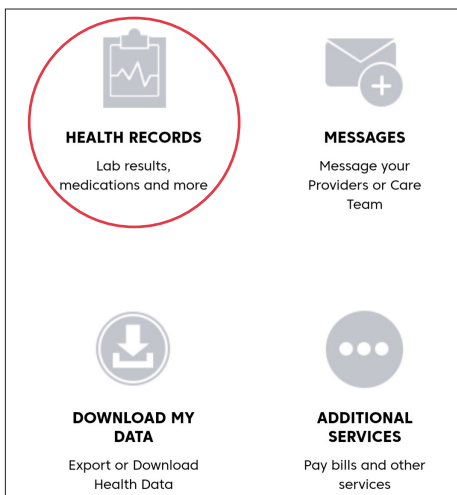

- HEALTH RECORDS**
Lab results, medications and more
- MESSAGES**
Message your Providers or Care Team
- DOWNLOAD MY DATA**
Export or Download Health Data
- ADDITIONAL SERVICES**
Pay bills and other services

To access results and view all tests, Click on "Health Records"

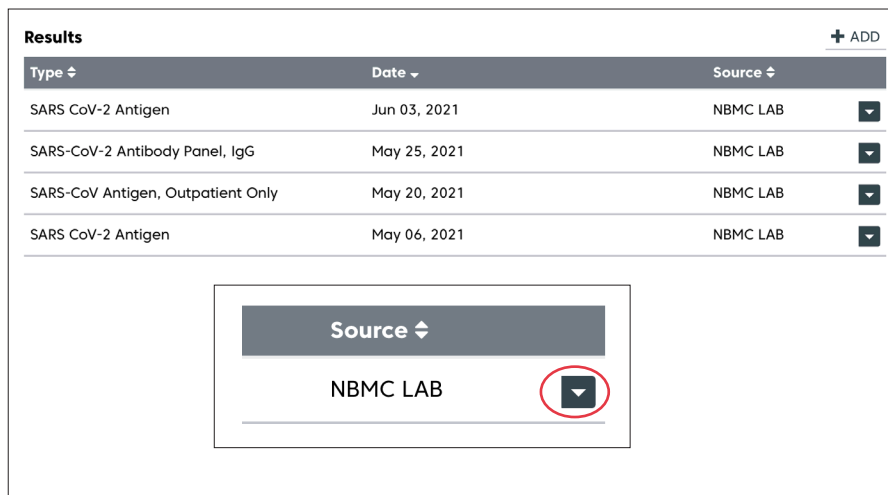

Type	Date	Source
SARS CoV-2 Antigen	Jun 03, 2021	NBMC LAB
SARS-CoV-2 Antibody Panel, IgG	May 25, 2021	NBMC LAB
SARS-CoV Antigen, Outpatient Only	May 20, 2021	NBMC LAB
SARS CoV-2 Antigen	May 06, 2021	NBMC LAB

Source: NBMC LAB

Tests will be listed, as shown above. Click on "Arrow" then click "View Results"

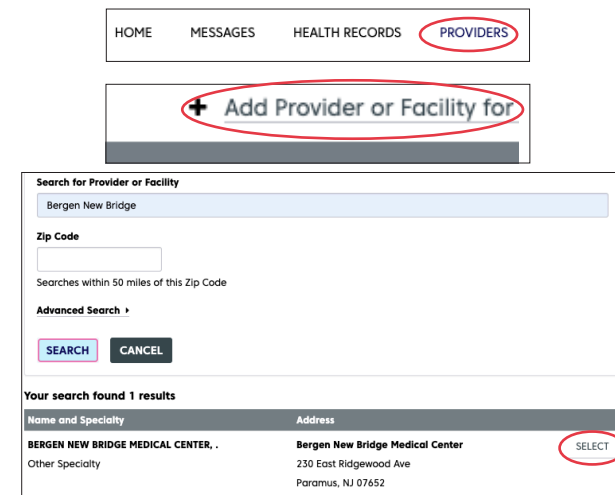

HOME MESSAGES HEALTH RECORDS **PROVIDERS**

+ Add Provider or Facility for

Search for Provider or Facility

Bergen New Bridge

Zip Code

Searches within 50 miles of this Zip Code

Advanced Search

SEARCH **CANCEL**

Your search found 1 results

Name and Specialty	Address
BERGEN NEW BRIDGE MEDICAL CENTER, .	Bergen New Bridge Medical Center
Other Specialty	230 East Ridgewood Ave Paramus, NJ 07652

SELECT

Make sure to connect with Bergen New Bridge. So the results can be linked with your account.